

# Pressure Sensor industrial Heavy Duty with internal diaphragm

**Accuracy 0,25 % and 0,5 %**

**Standard output 4...20 mA; 2-wire system  
or 0...20 mA; 3-wire system  
or 0...5 VDC; 3-wire system  
or 0...10 VDC; 3-wire system**

## Features

High overload protection  
Corrosion resistant ,stainless steel design  
Highly resistant to shock and vibration  
Good reproducibility



## Applications

Development and laboratory,  
Process engineering,  
Plant and apparatus construction,  
Hydraulics and pneumatics,

Model	SD-30	SD-32
<b>Accuracy</b>	0,5 % of full scale value	0,25 % of full scale value
<b>Ranges in bar</b>	0...0,1, ...0,25, ...0,4, ...0,6, 1, 1,6, 2,5, 4, 6, 10, 16, 25, 40, 60, 100, 160, 250, 400, 0...600, 1.000, 1.600, 2.500, 4.000 -0,6 / 0, -1 / 0, -1 / +0,6, -1 / +1,5, -1 / +3, -1 / +5, -1 / +9, -1 / +15, -1 / +24	
<b>Overload limit</b>	to 16 bar - 2,0 x from 25 to 600 bar - 2,0 x over 600 bar - 1,5 x	
<b>Sensor element</b>	from 0,1 to 16 bar piezoresistive, over 25 bar in Thin film	
<b>Repeability</b>	< 0,05 % full scale value	
<b>Stability per year</b>	< 0,2 % full scale value in rated conditions	
<b>Case</b>	CrNi steel	
<b>Wetted parts</b>	CrNi steel	
<b>Pressur connection</b>	SW 27 CrNi steel	
<b>Electrical connection</b>	plug according to DIN 43650 with junction box	
<b>Power supply</b>	10...30 VDC (14...30 VDC for output 0...10 V)	
<b>Power consumption</b>	Output 4...20 mA: signal currency	voltage output 8 mA
<b>Temp.comp.range</b>	0...80 °C	
<b>Temp. influence</b>	0,2 % / 10 K, zero point and measuring element	
<b>Response time</b>	(within 10% to 90% of full scale value)	
<b>Protection type</b>	IP 65 to EN 60529 /IEC 529	
<b>Temperatures</b>	Medium: -30°C up to 100°C, Ambient: -20°C up to 80°C	
<b>Weight</b>	0,2 kg	

## Dimensions and Design

with internal diaphragm

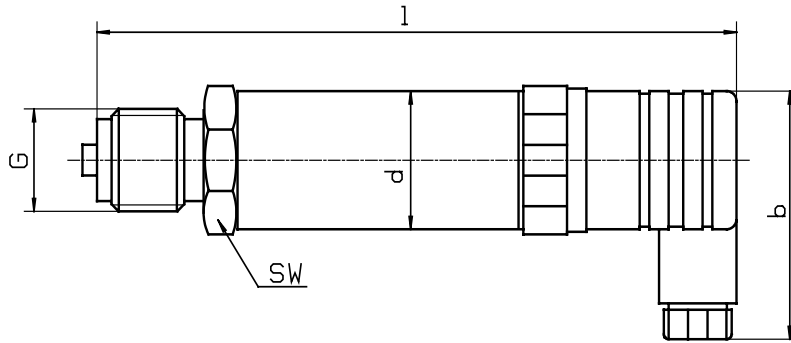

## Electrical connection

### Two-wire system

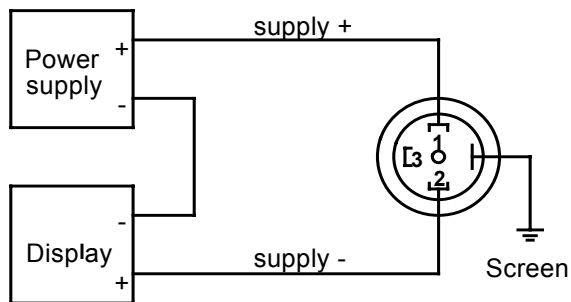

### Three - wire system

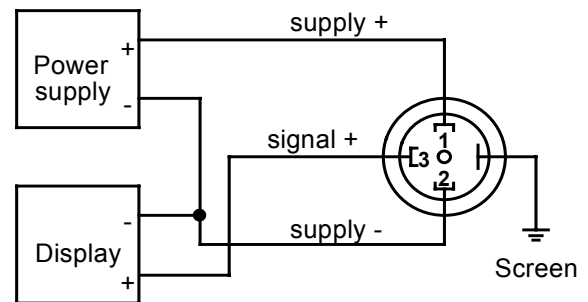

Dimensions in mm						
Model	b		d	l	SW	G
SD-30	48		27	133	27	G 1/2 B